

IM 151-3 PN



Design

The IM 151-3PN interface modules are snapped directly onto the DIN rail. IM 151-3PN features:

- Diagnostics indicators for group faults, bus faults and voltage supply, link, RX/TX
- Slot for SIMATIC MMC
- Labeling strips for identification
- 2 RJ45 sockets for connection to PROFINET

The scope of supply includes the terminating module that must be plugged into the last I/O module of the ET 200S. Up to 6 spare fuses (5 x 20 mm) for the PM-E power module 24 V DC to 230 V AC can be accommodated on this module.

Technical specifications

Technical specifications

	6ES7 151-3AA23-0AB0	6ES7 151-3BA23-0AB0
Supply voltages		
Supply voltage of electronics 1L+		
•Rated value (DC)	24 V	24 V
•reverse polarity protection	Yes	Yes
Mains/voltage failure jumpering, min.	20 ms	20 ms
Current consumption		
from supply voltage 1L+, max.	250 mA	250 mA
Current consumption/power loss		
Power loss, typ.	2.5 W	2.5 W
Address area		
Addressing volume		

•Outputs	256 byte	256 byte
•Inputs	256 byte	256 byte
interfaces		
automatic detection of transmission speed	Yes	Yes
Connection point		
RJ45	Yes	Yes
Protocols		
PROFINET IO	Yes	Yes
PROFINET IO		
Transmission speed, max.	100 MBit/s	100 MBit/s
Isochronous mode		
Isochronous mode	Yes	Yes
Status information/alarms/diagnostics		
Alarms		
•Alarms	Yes	Yes
Diagnoses		
•Diagnostic functions	Yes	Yes
Diagnostics indication LED		
•Bus error BF (red)	Yes	Yes
•Collective error SF (red)	Yes	Yes
•Monitoring 24 V voltage supply ON (green)	Yes	Yes

•Connection to network LINK (green)	Yes	Yes
•Maintenance (yellow)	Yes	Yes
Isolation		
between backplane bus and electronics	No	No
between supply voltage and electronics	No	No
between Ethernet and electronics	Yes	Yes
General information		
Vendor identification (VendorID)	002AH	002AH
Device identifier (DeviceID)	0301	0301H
Dimensions		
Dimensions		
•Width	60 mm	60 mm
•Height	119.5 mm	119.5 mm
•Depth	75 mm	75 mm
Weights		
•Weight, approx.	120 g	135 g

Dimensional drawings

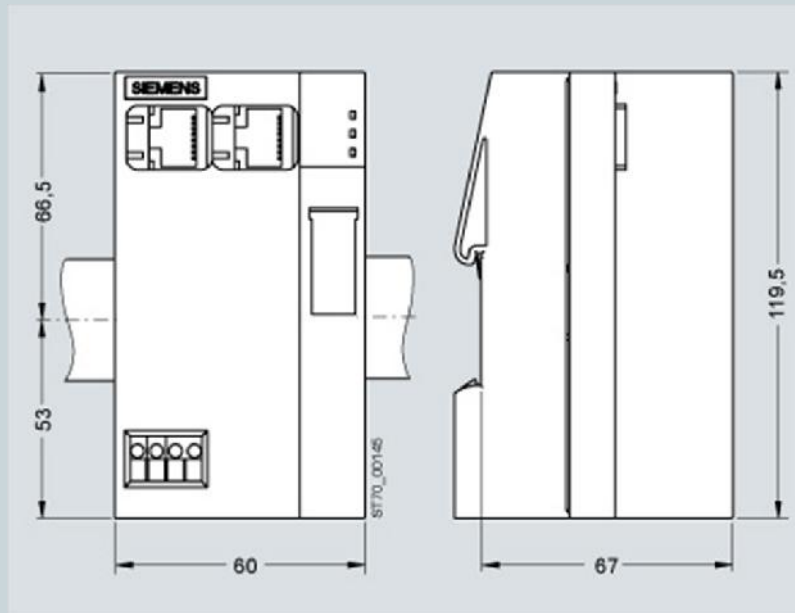

IM 151-3 PN / IM 151-3PN High
Feature interface module